

Appendix 1

FOR OFFICE USE			
Receipt No:	FEE REQUIRED:	Date:	Initials:
On-Line Payment Ref:			

This form should be completed and forwarded to: Licensing Section, Mulberry Place, 5 Clove Crescent, London E14 2BG with a cheque for the correct fee, made payable to the London Borough of Tower Hamlets.

On-Line payments can be made at:

http://www.towerhamlets.gov.uk/content_pages/pay_it.aspx

Or alternatively from <http://www.towerhamlets.gov.uk/> under 'Online Services'

**Application for a premises licence to be granted
under the Licensing Act 2003**

PLEASE READ THE FOLLOWING INSTRUCTIONS FIRST

Before completing this form please read the guidance notes at the end of the form. If you are completing this form by hand please write legibly in block capitals. In all cases ensure that your answers are inside the boxes and written in black ink. Use additional sheets if necessary.

You may wish to keep a copy of the completed form for your records.

I/We (*Insert name(s) of applicant*)

Kafe 1788 ltd/ Richard Macien

.....

apply for a premises licence under section 17 of the Licensing Act 2003 for the premises described in Part 1 below (the premises) and I/we are making this application to you as the relevant licensing authority in accordance with section 12 of the Licensing Act 2003.

Part 1 – Premises details

Kafe 1788 ltd 4 Vesey Path	
Post town London	Post code E14 6BT

Telephone number at premises (if any)

--

Non-domestic rateable value of premises

£ 10250

Part 2 - Applicant details

Please state whether you are applying for a premises licence as

Please tick as appropriate

- | | | | |
|----|---|--------------------------|-----------------------------|
| a) | an individual or individuals* | <input type="checkbox"/> | Please complete section (A) |
| b) | a person other than an individual * | | |
| | i. as a limited company | x | please complete section (B) |
| | ii. as a partnership | <input type="checkbox"/> | please complete section (B) |
| | iii. as an unincorporated association or | <input type="checkbox"/> | please complete section (B) |
| | iv. other (for example a statutory corporation) | <input type="checkbox"/> | please complete section (B) |
| c) | a recognised club | <input type="checkbox"/> | please complete section (B) |
| d) | a charity | <input type="checkbox"/> | please complete section (B) |
| e) | the proprietor of an educational establishment | <input type="checkbox"/> | please complete section (B) |
| f) | a health service body | <input type="checkbox"/> | please complete section (B) |
| g) | an individual who is registered under Part 2 of the Care Standards Act 2000 (c14) in respect of an independent hospital | <input type="checkbox"/> | please complete section (B) |
| h) | the chief officer of police of a police force in England and Wales | <input type="checkbox"/> | please complete section (B) |

*If you are applying as a person described in (a) or (b) please confirm:

Please tick as appropriate

- I am carrying on or proposing to carry on a business which involves the use of the premises for licensable activities; or
- I am making the application pursuant to a
 - statutory function or
 - a function discharged by virtue of Her Majesty's prerogative

(A) INDIVIDUAL APPLICANTS (fill in as applicable)

Mr Mrs Miss Ms Other title
(for example, Rev)

Surname

First names

I am 18 years old or over

Please tick yes

Current postal address if different from premises address

Post Town

Postcode

Daytime contact telephone number

E-mail address (optional)

SECOND INDIVIDUAL APPLICANT (if applicable)

Mr Mrs Miss Ms Other title
(for example, Rev)

Surname

First names

I am 18 years old or over

Please tick yes

Current postal address if different from premises address

Post Town

Postcode

Daytime contact telephone number

E-mail address (optional)

B) OTHER APPLICANTS

Please provide name and registered address of applicant in full. Where appropriate please give any registered number. In the case of a partnership or other joint venture (other than a body corporate), please give the name and address of each party concerned.

Name Kafe 1788 ltd
Address [REDACTED] [REDACTED] [REDACTED] [REDACTED]
Registered number (where applicable) 10070480
Description of applicant (for example partnership, company, unincorporated association etc) Limited Company
Telephone number, if any [REDACTED]
E-mail (optional) [REDACTED]

Part 3 Operating Schedule

When do you want the premises licence to start?

Day			Month			Year			
0	6		0	3		2	0	1	7

If you wish the licence to be valid only for a limited period, when do you want it to end?

Day			Month			Year			

If 5,000 or more people are expected to attend the premises at any one time, please state the number expected to attend.

Please give a general description of the premises (please read guidance note1)

Kafe 1788 is a coffee shop.

We are cooking and baked most of our food.

Alcohol will be provided with food mainly.

Most of the alcohol will be coming from beer supplier and majestic wines.

Alcohol will be consumed within the coffee shop only, no alcohol in to the street will be allowed.

What licensable activities do you intend to carry on from the premises?

(Please see sections 1 and 14 of the Licensing Act 2003 and Schedule 1 and 2 to the Licensing Act 2003)

Provision of regulated entertainment

Please tick all that apply

- | | |
|--|--------------------------|
| a) plays (if ticking yes, fill in box A) | <input type="checkbox"/> |
| b) films (if ticking yes, fill in box B) | x |
| c) indoor sporting events (if ticking yes, fill in box C) | <input type="checkbox"/> |
| d) boxing or wrestling entertainment (if ticking yes, fill in box D) | <input type="checkbox"/> |
| e) live music (if ticking yes, fill in box E) | x |
| f) recorded music (if ticking yes, fill in box F) | <input type="checkbox"/> |
| g) performances of dance (if ticking yes, fill in box G) | <input type="checkbox"/> |
| h) anything of a similar description to that falling within (e), (f) or (g)
(if ticking yes, fill in box H) | <input type="checkbox"/> |

Provision of late night refreshment (if ticking yes, fill in box L) x

Supply of alcohol (if ticking yes, fill in box M) x

In all cases complete boxes K, L and M

A

Plays Standard days and timings (please read guidance note 6)			Will the performance of a play take place indoors or outdoors or both - please tick (please read guidance note 2)	Indoors		
Day	Start	Finish		Outdoors		
Mon				Please give further details here (please read guidance note 3)	Both	
Tue						
Wed			State any seasonal variations for performing plays (please read guidance note 4)			
Thur						
Fri			Non standard timings. Where you intend to use the premises for performance of plays at different times to those listed in the column on the left, please list (please read guidance note 5)			
Sat						
Sun						

B

Films Standard days and timings (please read guidance note 6)			Will the exhibition of a film take place indoors or outdoors or both - please tick (please read guidance note 2)	Indoors	x
Day	Start	Finish		Outdoors	
Mon	12:00	23:00		Please give further details here (please read guidance note 3) Movie night will be held once a month (for now maybe more with the popularity) from 18:00 to 22:30 follow up by a Q&A	Both
Tue	12:00	23:00			
Wed	12:00	23:00	State any seasonal variations for exhibition of films (please read guidance note 4)		
Thur	12:00	23:00			

Fri	12:00	23:00	<u>Non standard timings. Where you intend to use the premises for exhibition of films at different times to those listed in the column on the left, please list</u> (please read guidance note 5)
Sat	12:00	23:00	
Sun	12:00	23:00	

C

Indoor sporting events Standard days and timings (please read guidance note 6)			<u>Please give further details here</u> (please read guidance note 3)
Day	Start	Finish	<p><u>State any seasonal variations for indoor sporting events</u> (please read guidance note 4)</p> <p><u>Non standard timings. Where you intend to use the premises for indoor sporting events at different times to those listed in the column on the left, please list</u> (please read guidance note 5)</p>
Mon			
Tue			
Wed			
Thur			
Fri			
Sat			
Sun			

D

<u>Boxing or wrestling entertainment</u> Standard days and timings (please read guidance note 6)			<u>Will the Boxing or wrestling entertainment take place indoors or outdoors or both - please tick</u> (please read guidance note 2)	Indoors	
				Outdoors	
				Both	
Day	Start	Finish	<u>Please give further details here</u> (please read guidance note 3)		
Mon					
Tue					
Wed				<u>State any seasonal variations for boxing or wrestling entertainment</u>	

			(please read guidance note 4)
Thur			
Fri			<u>Non standard timings. Where you intend to use the premises for boxing or wrestling entertainment at different times to those listed in the column on the left, please list</u> (please read guidance note 5)
Sat			
Sun			

E

Live music Standard days and timings (please read guidance note 6)			<u>Will the performance of live music take place indoors or outdoors or both – please tick [Y]</u> (please read guidance note 2)	Indoors	x
Day	Start	Finish		Outdoors	
Mon	12:00	23:00	<u>Please give further details here</u> (please read guidance) Every First Wednesday of the Month will be hosting an Open Mic session (More if really popular). Acts will be registered before so we have a night of live music. The event will start at 18:30 to 22:30 and everyone will be leaving the premises in quiet manner by 23:00.	Both	
Tue	12:00	23:00			
Wed	12:00	23:00	<u>State any seasonal variations for the performance of live music</u> (please read guidance note 4)		
Thur	12:00	23:00			
Fri	12:00	23:00	<u>Non standard timings. Where you intend to use the premises for the performance of live music at different times to those listed in the column on the left, please list</u> (please read guidance note 5)		
Sat	12:00	23:00			
Sun	12:00	23:00			

F

Recorded music Standard days and timings (please read guidance note 6)			<u>Will the playing of recorded music take place indoors or outdoors or both – please tick [Y]</u> (please read guidance note 2)	Indoors	
				Outdoors	
				Both	
Day	Start	Finish			
Mon			<u>Please give further details here</u> (please read guidance note 3)		
Tue					
Wed			<u>State any seasonal variations for playing recorded music</u> (please read guidance note 4)		
Thur					
Fri			<u>Non standard timings. Where you intend to use the premises for the playing of recorded music entertainment at different times to those listed in the column on the left, please list</u> (please read guidance note 5)		
Sat					
Sun					

G

Performances of dance Standard days and timings (please read guidance note 6)			<u>Will the performance of dance take place indoors or outdoors or both – please tick [Y]</u> (please read guidance note 2)	Indoors	X
				Outdoors	
				Both	
Day	Start	Finish			
Mon			<u>Please give further details here</u> (please read guidance note 3)		
Tue					
Wed			<u>State any seasonal variations for the performance of dance</u> (please read guidance note 4)		

Thur			
Fri			<u>Non standard timings. Where you intend to use the premises for the performance of dance entertainment at different times to those listed in the column on the left, please list</u> (please read guidance note 5) 5)
Sat			
Sun			

H

Anything of a similar description to that falling within (e), (f) or (g) Standard days and timings (please read guidance note 6)			<u>Please give a description of the type of entertainment you will be providing</u> Yoga and other soft course
Day	Start	Finish	
Mon	7:30	20:00	<u>Please give further details here</u> (please read guidance note 3) We will be hosting Yoga Session (now is only yoga but could host more soft activities)
Tue	7:30	20:00	
Wed	7:30	20:00	<u>State any seasonal variations for entertainment of a similar description to that falling within (e), (f) or (g)</u> (please read guidance note 4) During the summer will host other soft exercise class
Thur	7:30	20:00	
Fri	7:30	20:00	<u>Non standard timings. Where you intend to use the premises for the entertainment of similar description to that falling within (e), (f) or (g) at different times to those listed in the column on the left, please list</u> (please read guidance note 5)
Sat	7:30	20:00	
Sun	7:30	20:00	

I

<u>Late night refreshment</u> Standard days and timings (please read guidance note 6)			<u>Will the provision of late night refreshment take place indoors or outdoors or both – please tick [Y]</u> (please read guidance note 2)	Indoors	
Day	Start	Finish		Outdoors	
Mon	12:00	23:00	<u>Please give further details here</u> (please read guidance) Food Pop up or any food serving activity will be held from on Thursday to Saturday	Both	X
Tue	12:00	23:00			
Wed	12:00	23:00		<u>State any seasonal variations for the provision of late night refreshment</u> (please read guidance note 4) Food Pop up will be host within the premises during winter time and will extended to the exterior during warmer weather.	
Thur	12:00	23:00			
Fri	12:00	23:00			
Sat	12:00	23:00		<u>Non standard timings. Where you intend to use the premises for the provision of late night refreshment at different times to those listed in the column on the left, please list</u> (please read guidance note 5) Only for private rental will be providing late night refreshments on other days.	
Sun					

J

<u>Supply of alcohol</u> Standard days and timings (please read guidance note 6)			<u>Will the supply of alcohol be for consumption – please tick [Y]</u> (please read guidance note 7)	On the premises	
Day	Start	Finish		Off the premises	
Mon	12:00	23:00	<u>Please give further details here</u> (please read guidance) Alcohol will be served on site with our lunch time. We will be serving wine and beer mostly. Rum and whiskeys will be served for only events (pop up or tasting. No Alcohol consumption will be allowed outside the premise at any time of the day. Staff will reinforce the following before payment happen and signage will reinforce the following	Both	X
Tue	12:00	23:00			
Wed	12:00	23:00		<u>State any seasonal variations for the supply of alcohol</u> (please read guidance note 4) The site will be used for Beer, Wine, Whiskeys and Rum tasting with various partner Where people will be able to purchase from suppliers to consume in their home.	
Thur	12:00	23:00			

Fri	12:00	23:00	<p><u>Non standard timings. Where you intend to use the premises for the supply of alcohol at different times to those listed in the column on the left, please list</u> (please read guidance note 5)</p> <p>When alcohols tasting will occurred customers will be able to purchase alcohol to consume at their house. No alcohol will be consumed outside the shop.</p>
Sat	12:00	23:00	
Sun	12:00	23:00	

State the name and details of the individual whom you wish to specify on the licence as premises supervisor

Name

Richard Macien

Address

[Redacted Address]

Personal Licence number(if known)

[Redacted Licence Number]

Issuing licensing authority (if known)

[Redacted Issuing Authority]

K

Please highlight any adult entertainment or services, activities, other entertainment or matters ancillary to the use of the premises that may give rise to concern in respect of children (please read guidance note 8)

No Adults entertainment

L

Hours premises are open to the public Standard timings (please read guidance note 6)			<u>State any seasonal variation</u> (please read guidance note 4) Closing hours may varies between Monday to Sunday to adjust to trading needs but all events will be finished by 23:00
Day	Start	Finish	
Mon	7:30	23:00	
Tue	7:30	23:00	
Wed	7:30	23:00	
Thur	7:30	23:00	
Fri	7:30	23:00	
Sat	10:00	23:00	
Sun	11:00	23:00	

Non standard timings. Where you intend to the premises to be open at different times to those listed in the column on the left, please list (please read guidance note 5)
 The site will open later to accommodate Open Mic, Movie Night, Food Pop Up, Alcohol Tasting and Exhibitions.

M

Describe the steps you intend to take to promote the four licensing objectives:

a) General – all four licensing objectives (b,c,d,e) (please read guidance note 9)

- Poster with age restriction will be advertised around the bar area
- No smoking allowed (including electric cigarettes) inside the premises
- Fire exits will be kept clear at all time
- A license holder will be on site at all time
- No drinks allowed outside the premises
- On busy night only plastic cups will be given to customers
- Food will be supplied with alcohol
- No Children will be allowed on busy night (E.g. open Mic) except for special children event.

b) The prevention of crime and disorder

- Door will be kept closed during Open Mic to maintain the noise level low.
- Alcohol will be served and need to be consumed within the premises, no one will consume alcohol outside the premises at any time.
- Food will be served with alcohol so no one does drink with an empty stomach
- Alcohol will be served until 22:30 and the shop will have cleared off customers by 23:00
- 24 hrs CCTV is now installed within the premise and a specific accident report has been allocated for the events and alcohol sales

c) Public safety

- Capacity will be kept to under 70 guests while we are hosting our busiest events (Open Mic).
- All the staffs are food safety trained
- All the staffs are health and safety trained
- First aider will be on site at all time
- Fire officer will be on site at all time
- 24hrs CCTV will be installed on site

d) The prevention of public nuisance

Notices at the entrance and exits to remind customers to leave quietly.

No Alcohols will be allowed outside the premises

e) The protection of children from harm

Acts and Musicians will be selected to avoid strong language during the open Mic

Alcohol will be served to adults only

Poster with Age check will be put around till area.

ID will be requested if customers looks under 25 years' old

Children will need to be accompanied by an adult after when we are hosting any events

You have completed part 3 of this form. Below is a checklist for your assistance.

CHECKLIST:

Please tick to indicate agreement

- I have made or enclosed payment of the fee x
Insert On-Line Payment reference here if applicable : X87Q-9E78-9D22
- I have enclosed the plan of the premises x
- I have sent copies of this application and the plan (showing the area to be licensed) to responsible authorities and others where applicable x
- I have enclosed the consent form completed by the individual I wish to be Premises Supervisor, if applicable x
- I understand that I must now advertise my application x
- I understand that if I do not comply with the above requirements my application will be rejected

Part 4 – Signatures (please read guidance note 10)

IT IS AN OFFENCE, LIABLE ON CONVICTION TO A FINE UP TO LEVEL 5 ON THE STANDARD SCALE, UNDER SECTION 158 OF THE LICENSING ACT 2003, TO MAKE A FALSE STATEMENT IN OR IN CONNECTION WITH THIS APPLICATION

Signature of applicant or applicant’s solicitor or other duly authorised agent. (See guidance note 11) **If signing on behalf of the applicant please state in what capacity.**

Signature

.....

Date

Friday 10th March

.....

Capacity

Director of Kafe 1788

.....

For joint applications signature of 2nd applicant or 2nd applicant’s solicitor or other authorised agent. (please read guidance note 12) **If signing on behalf of the applicant please state in what capacity.**

Signature

.....

Date

.....

Capacity

.....

Contact name (where not previously given) and postal address for correspondence associated with this application (please read guidance note 13)

Post town

Post code

Telephone number (if any)

If you would prefer us to correspond with you by e-mail your e-mail address (optional)

Notes for Guidance

1. Describe the premises. For example the type of premises, its general situation and layout and any other information which could be relevant to the licensing objectives. Where your application includes off-supplies of alcohol and you intend to provide a place for consumption of these off-supplies you must include a description of where the place will be and its proximity to the premises.
2. Where taking place in a building or other structure please tick as appropriate. Indoors may include a tent.
3. For example the type of activity to be authorised, if not already stated, and give relevant further details, for example (but not exclusively) whether or not music will be amplified or un-amplified.
4. For example (but not exclusively), where the activity will occur on additional days during the summer months.
5. For example (but not exclusively), where you wish the activity to go on longer on a particular day, e.g. Christmas Eve.
6. Please give timings in 24 hour clock (e.g. 16:00) and only give details for the days of the week when you intend the premises to be used for the activity.
7. If you wish people to be able to consume alcohol on the premises please tick on, if you wish people to be able to purchase alcohol to consume away from the premises please tick off. If you wish people to be able to do both please tick both.
8. Please give information about anything intended to occur at the premises or ancillary to the use of the premises which may give rise to concern in respect of children, regardless of whether you intend children to have access to the premises, for example (but not exclusively) nudity or semi-nudity, films for restricted age groups, the presence of gaming machines.
9. Please list here steps you will take to promote all four licensing objectives together.
10. The application form must be signed.
11. An applicant's agent (for example solicitor) may sign the form on their behalf provided that they have actual authority to do so.
12. Where there is more than one applicant, both applicants or their respective agents must sign the application form.
13. This is the address which we shall use to correspond with you about this application.

Appendix 2

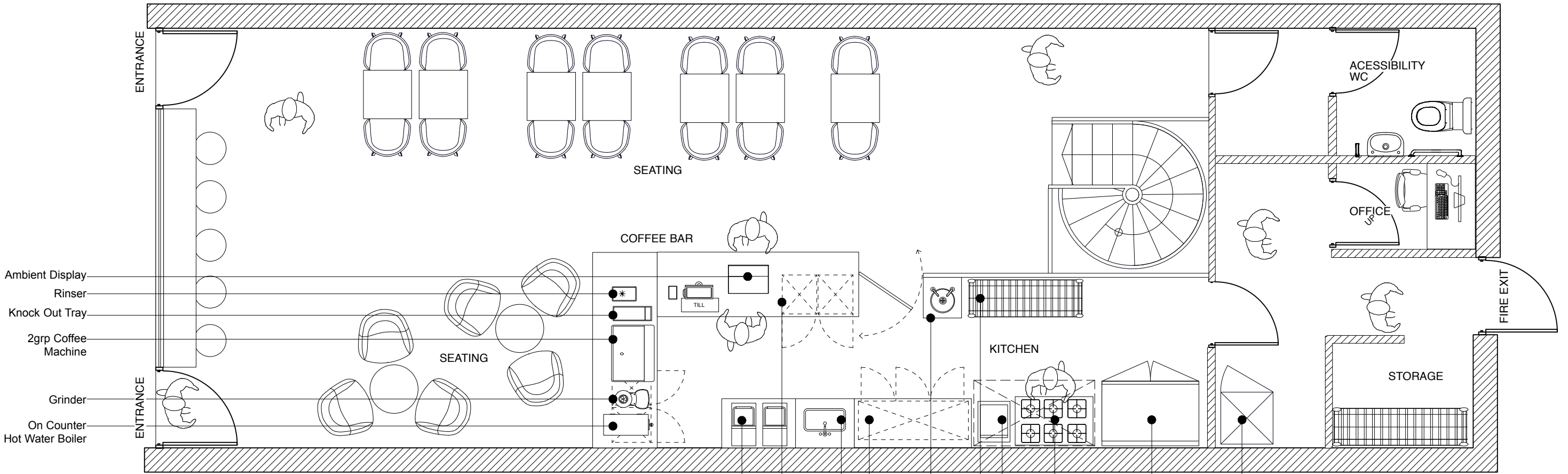

- Ambient Display
- Rinser
- Knock Out Tray
- 2grp Coffee Machine
- Grinder
- On Counter Hot Water Boiler

- x2 Panini grills
- x2 u/c single door fridge
- Food wash sink
- Hand wash basin
- Fryer
- Dry food store
- Cooker
- Upright double door fridge
- Upright single door freezer

1 GA
Scale: 1.50 @ A3

NOTE:
FOR COSTING PURPOSES ONLY.
DRAWING NOT FOR CONSTRUCTION
ALL DIMENSIONS TBC BY CLIENT AND SITE SURVEY

DESCRIPTION		
Equipment		
CLIENT Macien Clarke		
PROJECT KAFF 1788		
ADDRESS 4 Vesey Path, London		
JOB No.	DWG No.	REV.
	016 01.2	-
DATE	STATUS	
MAY 16	COSTING	
DWN BY TV		
SCALE 1:150 @A3		

THIS DRAWING IS FOR DESIGN INTENT PURPOSES ONLY. DO NOT SCALE THIS DRAWING
• Contractors should provide their own setting out drawings for comment by KAO CREATIVE.
 • This drawing is the property of KAO CREATIVE and copyright is reserved by them.
 • All structural works are to be detailed / confirmed and approved by structural engineer.
 • All dimensions to be verified on site prior to work commencing.
 • This drawing is issued on condition that it is not copied or disclosed to any other unauthorised person without the prior consent of KAO CREATIVE.

Appendix 3



4 Vesey Path



Scale 1:769

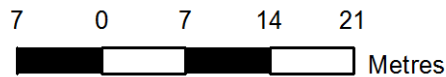

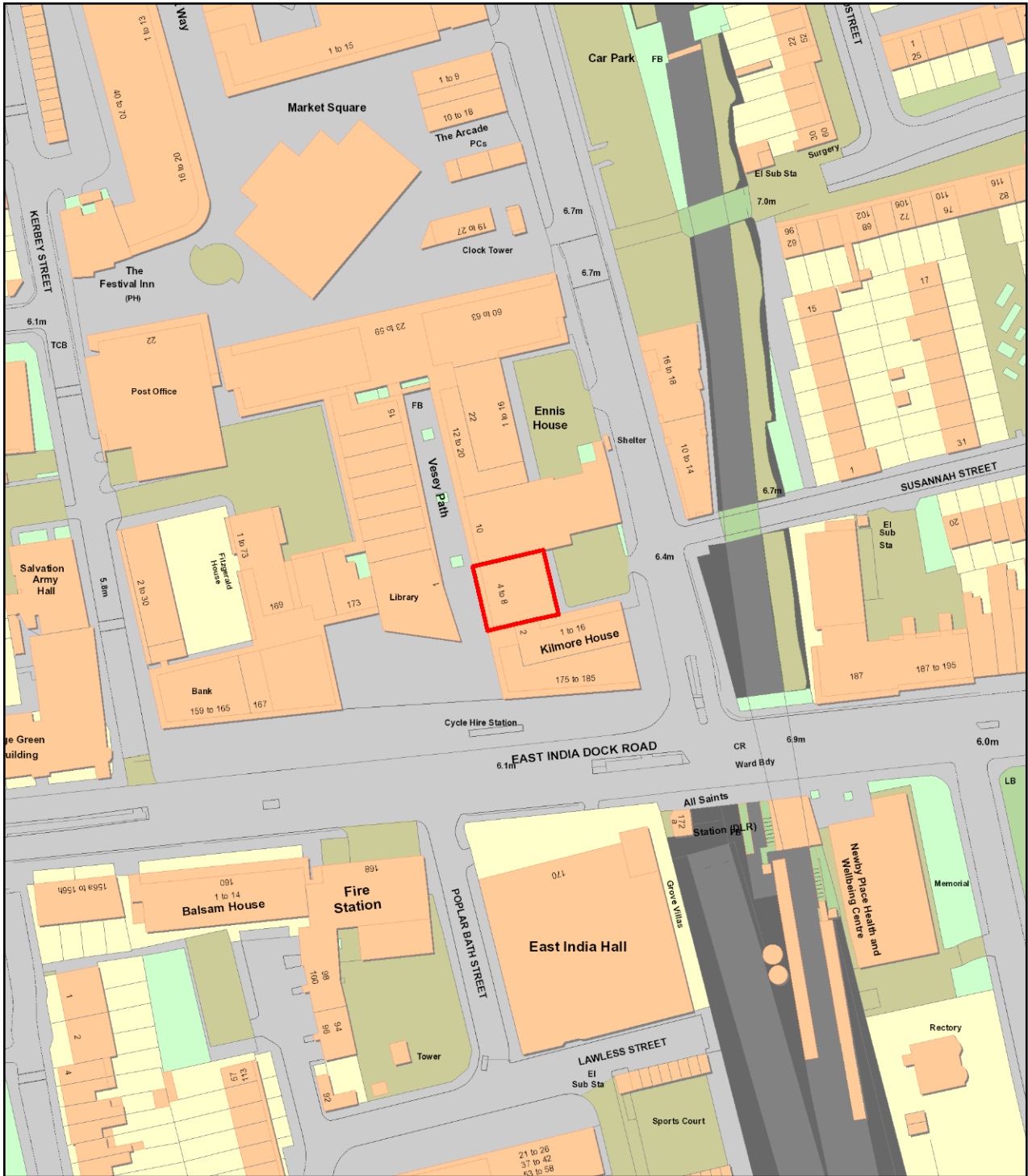

4 Vesey Path



Scale 1:1537

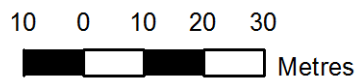

Appendix 4

Application for (Kafe 1788 Ltd), 4 Vesey Path, London E14 6BT

Name and address	Licensable activities and hours	Opening hours
<p>(Iceland Foods Ltd) 10 Vesey Path London E14 6BT</p>	<p><u>The Supply of Alcohol (off sales only)</u></p> <ul style="list-style-type: none"> • Monday to Sunday from 07:00hrs to 23:00hrs 	<ul style="list-style-type: none"> • Monday to Sunday from 07:00hrs to 23:00hrs
<p>(Perfect Fried Chicken) 197 East India Dock Road London E14 0ED</p>	<p>The provision of late night refreshment</p> <ul style="list-style-type: none"> • Monday to Sunday 23:00 hours – 02:00 hours (the following day) 	<ul style="list-style-type: none"> ▪ Monday to Sunday, from 11:00 hours to 00:00 hours (midnight) <p><u>Non-standard timings:</u></p> <ul style="list-style-type: none"> ▪ New Year's Eve, from 11:00 hours to 02:00 hours the following day
<p>(Manor Arms) 150 East India Dock Road Poplar London E14 0BP</p>	<p>Sale of Alcohol (On and off sales) Sunday to Thursday from 09:00 hours to 23:00 hours Friday and Saturday from 09:00 hours to 23:30 hours</p> <p>The Provision for Regulated Entertainment – Indoors <u>Films and Indoor Sporting Events.</u> <u>Performance of dance and anything of a similar description.</u></p> <p>Monday to Sunday from 09:00 hours to 23:00 hours</p> <p><u>Live Music and Recorded Music</u> Friday to Sunday and Public Holidays from 09:00 hours to 23:00 hours</p> <p>The Provision for Late Night Refreshments</p> <ul style="list-style-type: none"> • Friday and Saturday from 23:00 hours to 23:30 hours <p><u>Non-standard timings</u> From the end of permitted hours on New Years Eve to the beginning of permitted hours on New Years Day.</p>	<ul style="list-style-type: none"> • Sunday to Thursday from 09:00 hours to 23:30 hours • Friday and Saturday from 09:00 hours to 00:00 hours (midnight)

Application for (Kafe 1788 Ltd), 4 Vesey Path, London E14 6BT

(Nisa) 175-179 East India Dock Road London E14 0EA	The sale by retail of alcohol (Off sales only) <ul style="list-style-type: none">Monday, Tuesday, Wednesday, Thursday, Friday, Saturday and Sunday from 07:00 hours to 23:00 hours	Monday, Tuesday, Wednesday, Thursday, Friday, Saturday and Sunday from 07:00 hours to 23:00 hours
(Real Taste) 185 East India Dock Road London E14 0EA	The provision of late night refreshment <ul style="list-style-type: none">Monday to Wednesday from 23:00hrs to 00:30hrs (the following day)Thursday to Saturday from 23:00hrs to 02:00hrs (the following day)	<ul style="list-style-type: none">Monday to Wednesday from 08:00hrs to 00:30hrs (the following day)Thursday to Saturday from 08:00hrs to 02:00hrs (the following day)Sunday from 08:00hrs to 23:00hrs

Appendix 5

Section 182 Advice by the Home Office Updated on March 2015

Relevant, vexatious and frivolous representations

- 9.4 A representation is “relevant” if it relates to the likely effect of the grant of the licence on the promotion of at least one of the licensing objectives. For example, a representation from a local businessperson about the commercial damage caused by competition from new licensed premises would not be relevant. On the other hand, a representation by a businessperson that nuisance caused by new premises would deter customers from entering the local area, and the steps proposed by the applicant to prevent that nuisance were inadequate, would be relevant. In other words, representations should relate to the impact of licensable activities carried on from premises on the objectives. For representations in relation to variations to be relevant, they should be confined to the subject matter of the variation. There is no requirement for a responsible authority or other person to produce a recorded history of problems at premises to support their representations, and in fact this would not be possible for new premises.
- 9.5 It is for the licensing authority to determine whether a representation (other than a representation from responsible authority) is frivolous or vexatious on the basis of what might ordinarily be considered to be vexatious or frivolous. A representation may be considered to be vexatious if it appears to be intended to cause aggravation or annoyance, whether to a competitor or other person, without reasonable cause or justification. Vexatious circumstances may arise because of disputes between rival businesses and local knowledge will therefore be invaluable in considering such matters. Licensing authorities can consider the main effect of the representation, and whether any inconvenience or expense caused by it could reasonably be considered to be proportionate.
- 9.6 Frivolous representations would be essentially categorised by a lack of seriousness. Frivolous representations would concern issues which, at most, are minor and in relation to which no remedial steps would be warranted or proportionate.
- 9.7 Any person who is aggrieved by a rejection of their representations on either of these grounds may lodge a complaint through the local authority’s corporate complaints procedure. A person may also challenge the authority’s decision by way of judicial review.

- 9.8 Licensing authorities should not take decisions about whether representations are frivolous, vexatious or relevant to the licensing objectives on the basis of any political judgement. This may be difficult for councillors who receive complaints from residents within their own wards. If consideration is not to be delegated, contrary to the recommendation in this Guidance, an assessment should be prepared by officials for consideration by the sub- committee before any decision is taken that necessitates a hearing. Any councillor who considers that their own interests are such that they are unable to consider the matter independently should disqualify themselves.
- 9.9 It is recommended that, in borderline cases, the benefit of the doubt about any aspect of a representation should be given to the person making that representation. The subsequent hearing would then provide an opportunity for the person or body making the representation to amplify and clarify it.
- 9.10 Licensing authorities should consider providing advice on their websites about how any person can make representations to them.

Appendix 6

Mohshin Ali

From: Mohshin Ali on behalf of Licensing
Sent: 03 April 2017 10:57
To: Mohshin Ali
Subject: FW: Licensing for 4 Vessey Path London E14 6BT
Attachments: Objection Letter 4 vesey path.docx

From: Prime Wholesale UK [REDACTED]
Sent: 01 April 2017 14:38
To: Licensing
Subject: Re: Licensing for 4 Vessey Path London E14 6BT

pls see attached, they have reapplied but we have not been given new reference number so pls could you apply this to this property.

--

Many Thanks

Mr Hasanie

Prime Wholesale UK Ltd
[REDACTED]
[REDACTED]
[REDACTED]
[REDACTED]
[REDACTED]

Kathy Driver
Licensing Section
John Onslow House
1 Ewart Place
London E3 5EQ

Re: Kafe 1788 Ltd, 4 Vesey Path, London E14 6BT.

Your Ref: CLC/EHTS/LIC/098417

Dear Kathy,

I am writing to register **my objection** to the application for a premises licence by **Kafe 1788 Ltd, 4 Vesey Path, London E14 6BT**. The basis for this opposition is that granting a licence for these premises will not promote the licensing objectives, particularly the prevention of crime, disorder and antisocial behaviour.

4 Vesey Path, lies within the Council's Cumulative Impact Area, and enabling another premises to sell alcohol late into the night would be totally detrimental to its aims and objectives. The application proposes that alcohol and food will be served / sold for consumption on & off the premises. Granting a licence would provide a further source of alcohol within an area already so heavily populated with licensed premises that crime, disorder and public nuisance have already reached problem levels for the local police.

Residents in this area already suffer noise nuisance and antisocial behaviour at all hours of the day and night. They have endured this inconvenience since 2003 when the licensing legislation was first amended, and it is totally unacceptable to expect them to continue to do so.

I would also urge the Committee to consider the findings of the Health Impact Assessment, in which evidence of the negative effects of the flexible licensing hours was put forward by local residents back in the 2004 approx.

In light of this it will also increase the load on the local Police to control and safe guard the local residence and prevent vandalism in late hours of the night. Entertainment to be played late into the night would not be acceptable as it is below and surrounded by residential area. We already suffer from anti-social behaviour and vandalism and this would only fuel it more.

In view of the above, I would urge the Licensing Authority to refuse the application.

Yours faithfully,

Mr M Hasanie

██████████

██████████

Appendix 7

Mohshin Ali

From: Andrew Heron on behalf of Licensing
Sent: 10 February 2017 16:37
To: Mohshin Ali
Subject: FW: Premise License Application - Kafe 1788 Ltd 4 Vesey Path, London rtef M/098417

From: Nicola Cadzow
Sent: 10 February 2017 15:53
To: Licensing
Cc: Alan.D.Cruickshank [REDACTED]; MARK.J.Perry [REDACTED]; richard [REDACTED]
Subject: FW: Premise License Application - Kafe 1788 Ltd 4 Vesey Path, London rtef M/098417

Dear Licensing,

I have no objections to this Premise License Application for Kafe 1788 Ltd 4 Vesey Path, London rtef M/098417 , further to confirmation by the Applicant to the amendments and the conditions as below:-

Licensable Activities:- Films, Live Music, Sale of Alcohol until 22:30 hours, with premises closing 30 minutes later at 23:00 hours

Late Night refreshment is not required as closing at 23:00 hours

Anything of a Similar Description (Section H of the Application) - remains as original application.

The following conditions to apply:

- 1) no noise shall emanate from the premises nor vibration be transmitted through the structure of the premises which gives rise to a nuisance.
- 2) Loudspeakers shall not be located in the entrance lobby or outside the premises building.
- 3) All windows and external doors shall be kept closed after **22:00 hours**, or at any time when regulated entertainment takes place, except for the immediate access & egress of persons.

Kind regards

Nicola Cadzow
Environmental Health Technical Officer
Place Directorate
Public Realm - Environmental Health and Trading Standards
London Borough of Tower Hamlets 5 Clove Crescent London, E14 2BG

From: richard [redacted] [mailto:richard [redacted]]
Sent: 10 February 2017 15:39
To: Nicola Cadzow
Cc: Alan.D.Cruickshank [redacted]; MARK.J.Perry [redacted]
Subject: RE: Premise License Application - Kafe 1788 Ltd 4 Vesey Path, London rtef M/098417

Hi Nicola,

Many thanks for your email.
I can confirm my agreement and the following points you have raised.
I will incorporate those on any of the events.
Many thanks for your help.

Kind Regards

Richard

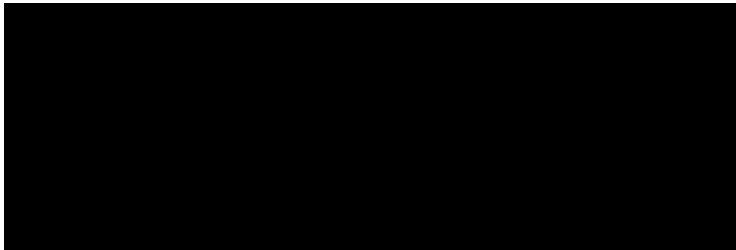

----- Original Message -----

Subject: Premise License Application - Kafe 1788 Ltd 4 Vesey Path, London rtef M/098417
From: "Nicola Cadzow" <Nicola.Cadzow [redacted]>
Date: 2/10/17 1:14 pm
To: "richard [redacted]" <richard [redacted]>
Cc: "Alan.D.Cruickshank [redacted]" <Alan.D.Cruickshank [redacted]>
"MARK.J.Perry [redacted]" <MARK.J.Perry [redacted]>

Dear Richard,

Further to our discussion today, please confirm you agreement to the following amendments:

Licensable Activities:- Films, Live Music, Sale of Alcohol until 22:30 hours, with premises closing 30 minutes later at 23:00 hours

Late Night refreshment is not required as closing at 23:00 hours

Anything of a Similar Description (Section H of the Application) -
remains as original application.

The following conditions to apply:

- 1) no noise shall emanate from the premises nor vibration be transmitted through the structure of the premises which gives rise to a nuisance.
- 2) Loudspeakers shall not be located in the entrance lobby or outside the premises building.
- 3) All windows and external doors shall be kept closed after **22:00 hours**, or at any time when regulated entertainment takes place, except for the immediate access & egress of persons.

I await your reply in due course.

Kind regards

Nicola Cadzow

Environmental Health Technical Officer

Place Directorate

Public Realm - Environmental Health and Trading Standards

London Borough of Tower Hamlets 5 Clove Crescent London, E14 2BG

*

Working Together for a Better Tower Hamlets

Web site : <http://www.towerhamlets.gov.uk>

London Borough of Tower Hamlets E-Mail Disclaimer.

This communication and any attachments are intended for the addressee only and may be confidential. It may contain privileged and confidential information and if you are not the intended recipient, you must not copy, distribute or take any action in reliance on it. If you have received this E-Mail in error please notify us as soon as possible and delete this E-Mail and any attachments. This message has been checked for viruses, however we cannot guarantee that this message or any attachment is virus free or has not been intercepted or amended. The information contained in this E-Mail may be subject to public disclosure under the Freedom of Information Act 2000. Unless the information is legally exempt from disclosure, the Confidentiality of this E-Mail and your reply cannot be guaranteed.

Appendix 8

Mohshin Ali

From: Mohshin Ali on behalf of Licensing
Sent: 14 February 2017 14:06
To: Mohshin Ali
Subject: FW: Premise License Application - Kafe 1788 Ltd 4 Vesey Path, London rtef M/098417

Follow Up Flag: Follow up
Flag Status: Flagged

From: MARK.J.Perry [redacted] [mailto:MARK.J.Perry [redacted]]
Sent: 14 February 2017 09:17
To: richard [redacted]
Cc: Licensing
Subject: RE: Premise License Application - Kafe 1788 Ltd 4 Vesey Path, London rtef M/098417

Hi Richard,

Thanks for agreeing the conditions, I have copied in Tower Hamlets Licensing so they are aware and can update the license.

If you need any assistance in the future please don't hesitate to contact me.

Regards

Mark

PC Mark Perry
Police Licensing Officer
Toby Club
Vawdry Close
E1 9UA

From: richard [redacted] [mailto:richard [redacted]]
Sent: 14 February 2017 09:09
To: Perry MARK J - HT
Subject: RE: Premise License Application - Kafe 1788 Ltd 4 Vesey Path, London rtef M/098417

Hi Mark,

Those two conditions are feasible within the business.
As we have an incident book already and we use it for incident in the shop.
I will have one for alcohol or event related.
It was ordered yesterday so should be with me by the end of the week.

Kind Regards

Richard

----- Original Message -----

Subject: RE: Premise License Application - Kafe 1788 Ltd 4 Vesey Path, London rtef M/098417

From: [MARK.J.Perry](#) [REDACTED]

Date: 2/14/17 8:02 am

To: [richard](#) [REDACTED]

Hi,

Thanks for the reply. I appreciate that it will take time for the CCTV to be installed.

With the incident book as long as it records all the incidents at the premises like any crime such as stolen property / disorder or refusals of sale of alcohol then that should be fine.

Can you just confirm that the 2 conditions I propose are acceptable to you please.

If you have any questions or need any assistance then please don't hesitate to contact me regards

Mark

PC Mark Perry
Police Licensing Officer
Toby Club
Vawdry Close
E1 9UA

From: [richard](#) [REDACTED] [<mailto:richard> [REDACTED]]

Sent: 13 February 2017 20:53

To: Perry MARK J - HT

Cc: [Nicola.Cadzow](#) [REDACTED]

Subject: RE: Premise License Application - Kafe 1788 Ltd 4 Vesey Path, London rtef M/098417

Hi Mark,

Many thanks for your email.

I will have the following organised.

A CCTV will be delivered in the shop soon and set up as requested.

I will train my team so any one can manipulate CCTV footage if needed.

A accident will be put in the shop to record any issues in the store.

Many thanks for the support on that matter.

Kind Regards

Richard



----- Original Message -----

Subject: RE: Premise License Application - Kafe 1788 Ltd 4 Vesey Path,
London rtef M/098417

From: [MARK.J.Perry](#) [redacted] <[k](#)>

Date: 2/13/17 2:20 pm

To: [richard](#) [redacted]

Cc: [Nicola.Cadzow](#) [redacted]

Hi Richard,

I am PC Mark Perry 748HT from Tower Hamlets Police Licensing. I am happy with the hours Nicola has agreed with you.

I would also like the following conditions added to the license:

1) A CCTV system to be put in place, the cameras are to be of sufficient quality so that peoples faces are clearly identifiable from the footage. The cameras are to be placed in such a way as they cover areas of the pub specified by the Police.

The system is to record the footage and to keep it for a minimum of 30 days and a copy off CCTV footage is to be made available to Police or the Local Authority upon request and supplied within 24 hours.

While the premises are open to the public a member of staff must be on duty who can operate the CCTV system.

2) A incident record book is to be kept at the premises, this book will record all refusals of the sale of alcohol, all disorder and crimes that occur either in the premises or involve the premises customers, or any other incident of note. The incident book is to be signed off every day by the manager even if there is nothing to report.

Please have a look at the conditions and let me know if they are acceptable.

If you would like to discuss this then please feel free to contact me.

Regards

Mark

PC Mark Perry
Police Licensing Officer
Toby Club
Vawdry Close
E1 9UA

From: Nicola Cadzow [<mailto:Nicola.Cadzow>]
Sent: 10 February 2017 15:53
To: Licensing
Cc: Cruickshank Alan D - HT; Perry MARK J - HT;
[richard](#)
Subject: FW: Premise License Application - Kafe 1788 Ltd 4 Vesey Path, London rref M/098417

Dear Licensing,

I have no objections to this Premise License Application for Kafe 1788 Ltd 4 Vesey Path, London rref M/098417 , further to confirmation by the Applicant to the amendments and the conditions as below:-

Licensable Activities:- Films, Live Music, Sale of Alcohol until 22:30 hours, with premises closing 30 minutes later at 23:00 hours

Late Night refreshment is not required as closing at 23:00 hours

Anything of a Similar Description (Section H of the Application) - remains as original application.

The following conditions to apply:

- 1) no noise shall emanate from the premises nor vibration be transmitted through the structure of the premises which gives rise to a nuisance.

2) Loudspeakers shall not be located in the entrance lobby or outside the premises building.

3) All windows and external doors shall be kept closed after **22:00 hours**, or at any time when regulated entertainment takes place, except for the immediate access & egress of persons.

Kind regards

Nicola Cadzow

Environmental Health Technical Officer

Place Directorate

Public Realm - Environmental Health and Trading Standards

London Borough of Tower Hamlets 5 Clove Crescent London, E14 2BG

From: [richard\[REDACTED\]](mailto:richard[REDACTED]) [[mailto:richard\[REDACTED\]](mailto:richard[REDACTED])]
Sent: 10 February 2017 15:39
To: Nicola Cadzow
Cc: [Alan.D.Cruickshank\[REDACTED\]](mailto:Alan.D.Cruickshank[REDACTED]); [MARK.J.Perry\[REDACTED\]](mailto:MARK.J.Perry[REDACTED])
Subject: RE: Premise License Application - Kafe 1788 Ltd 4 Vesey Path, London ref M/098417

Hi Nicola,

Many thanks for your email.

I can confirm my agreement and the following points you have raised.

I will incorporate those on any of the events.

Many thanks for your help.

Kind Regards

Richard

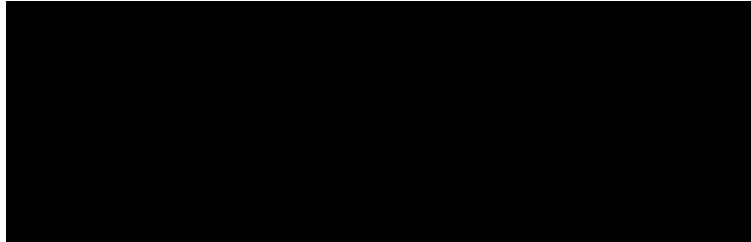

----- Original Message -----

Subject: Premise License Application - Kafe 1788 Ltd 4
Vesey Path, London rref M/098417

From: "Nicola Cadzow"

<Nicola.Cadzow>

Date: 2/10/17 1:14 pm

To: "richard" <richard>

Cc: "Alan.D.Cruickshank"

<Alan.D.Cruickshank>

"MARK.J.Perry"

<MARK.J.Perry>

Dear Richard,

Further to our discussion today, please confirm you
agreement to the following amendments:

Licensable Activities:- Films, Live Music, Sale of Alcohol
until 22:30 hours, with premises closing 30 minutes later at
23:00 hours

Late Night refreshment is not
required as closing at 23:00 hours

Anything of a Similar Description
(Section H of the Application) - remains as original
application.

The following conditions to apply:

- 1) no noise shall emanate from the premises nor vibration be transmitted through the structure of the premises which gives rise to a nuisance.
- 2) Loudspeakers shall not be located in the entrance lobby or outside the premises building.
- 3) All windows and external doors shall be kept closed after **22:00 hours**, or at any time when regulated entertainment takes place, except for the immediate access & egress of persons.

I await your reply in due course.

Kind regards

Nicola Cadzow

Environmental Health Technical Officer

Place Directorate

Public Realm - Environmental Health and Trading Standards

London Borough of Tower Hamlets 5 Clove Crescent London, E14 2BG

Working Together for a Better Tower Hamlets

Web site : <http://www.towerhamlets.gov.uk>

London Borough of Tower Hamlets E-Mail Disclaimer.

Appendix 9

Noise while the premise is in use

General Advice

If they conclude this is a problem Members should consider whether it is possible to carry out suitable and proportionate noise control measures so that noise leakage is prevented. In addition Members may consider that only certain activities are suitable.

The hours of operation also need to be considered (see below).

If Members believe that there is a substantial problem of noise while the premises are in use and it cannot be proportionately address by licensing conditions they should refuse the application.

Licensing Policy

The policy recognises that noise nuisance can be an issue, especially if a premises is open late at night. **(See Sections 8.1 of the Licensing Policy)**.

While all applications will be considered on their merits, consideration will be given to imposing stricter conditions in respect of noise control where premises are situated close to local residents. **(See Section 12.11)**.

The Licensing Authority expects the applicant to have addressed all nuisance issues relating to the premises in their operating schedule and to have sought appropriate advice from the Council's Environmental Health Officers. **(See Section 8.2 of the Licensing Policy)**.

The Licensing Authority will consider attaching conditions to prevent nuisance and these may include Conditions drawn from the Model Poll of Conditions relating to Crime and Disorder. **(See Appendix 2 Annex D of the Licensing Policy)**. In particular Members may wish to consider (this list is not exhaustive):

- hours of opening (this needs to be balanced against potential disorder caused by artificially early closing times)
- Whether certain parts should close earlier than the rest (for example a "beer garden", or restricted in their use)
- Whether or not certain activities should have to close at an early hour, for example live music
- Conditions controlling noise or vibration (for example, noise limiters, keeping doors and windows closed).
- Prominent clear and legible notices at all exits requesting the public to respect the needs of local residents and leave the premises and area quietly
- Conditions controlling the use of explosives, pyrotechnics and fireworks
- Conditions controlling the placing of refuse
- Conditions controlling noxious smells

- Conditions controlling lighting (this needs to be balanced against potential crime prevention benefits)

Police Powers

Part 8 of the Licensing Act 2003 enables a senior police officer to close down a premises for up to 24 hrs. a premises causing a nuisance resulting from noise emanating from the premises.

Guidance Issued under Section 182 of the Licensing Act 2003

The Licensing Policy has adopted the recommended Pool of Conditions as permitted (13.20 and Annex D).

The prevention of public nuisance could include low-level nuisance, perhaps affecting a few people living locally as well as major disturbance affecting the whole community (2.33).

Licence conditions should not duplicate other legislation (1.16).

Necessary and appropriate conditions should normally focus on the most sensitive periods (2.36) and may address disturbance as customers enter or leave the premises but it is essential that conditions are focused on measures within the direct control of the licence holder (2.38).

Other Legislation

The Environmental Protection Act 1990, Part 111 gives Environmental Health Officers the power to deal with statutory nuisances.

The Anti-social Behaviour Act 2003, Sections 40 and 41 give Environmental Health Officers the power of closure up to 24 hours in certain circumstances.

Appendix 10

Access and Egress Problems

Such as:

Disturbance from patrons arriving/leaving the premises on foot

Disturbance from patrons arriving/leaving the premises by car

Lack of adequate car parking facilities

Close proximity to residential properties

Comment

The above have been grouped together as egress problems. Of course the particular facts will be different for each alleged problem.

Egress only is referred to-if necessary access can be added or substituted in.

General Advice

In considering concerns relating to disturbance from egress, Members need to be satisfied that the premises under consideration has been identified as the source of the actual or potential disturbance. If they are satisfied that this is a problem, then proportionate conditions should be considered.

The hours of operation also need to be considered.

If Members believe that there is a substantial problem concerning egress and it cannot be proportionately addressed by licensing conditions, they should refuse the application.

Licensing Policy

The policy recognises that noise nuisance can be an issue, especially if a premises is open late at night. **(See Section 10 of the Licensing Policy)**.

The Licensing Authority expects the applicant to have addressed all nuisance issues relating to the premises in their operating schedule and to have sought appropriate advice from the Council's Environmental Health Officers. **(See Section 10.2 of the Licensing Policy)**.

The policy also recognises that staggered closing can help prevent problems at closure time **(See Section 15.1)**.

However, while all applications will be considered on their merits, consideration will be given to imposing stricter conditions in respect of noise control where premises are situated close to local residents. **(See Section 15.5)**

The Council has adopted a set of framework hours **(See 15.8 of the licensing policy)**. This relates to potential disturbance caused by late night trading.

The Licensing Authority will consider attaching conditions to prevent nuisance and these may include Conditions drawn from the Model Pool of Conditions relating to the prevention of Public Nuisance. (**See Annex G of the Licensing Policy**). In particular Members may wish to consider (this list is not exhaustive):

- hours of opening (this needs to be balanced against potential disorder caused by artificially early closing times)
- Whether certain parts should close earlier than the rest (for example a “beer garden”, or restricted in their use)
- Whether or not certain activities should have to close at an early hour, for example live music
- Conditions controlling noise or vibration (for example, noise limiters, keeping doors and windows closed).
- Prominent clear and legible notices at all exits requesting the public to respect the needs of local residents and leave the premises and area quietly

Guidance Issued under Section 182 of the Licensing Act 2003

The prevention of public nuisance could include low-level nuisance, perhaps affecting a few people living locally as well as major disturbance affecting the whole community. (2.19).

Licence conditions should not duplicate other legislation (1.16).

Any conditions should be tailored to the type, nature and characteristics of the specific premises. Licensing authorities should be aware of the need to avoid inappropriate or disproportionate measures that could deter events that are valuable to the community, such as live music. Noise limiters, for example, are very expensive to purchase and install and are likely to be a considerable burden for smaller venues. (2.20)

Measures can include ensuring the safe departure of customers, these can include:

- Providing information on the premises of local taxi companies who can provide safe transportation home; and
- Ensuring adequate lighting outside the premises, particularly on paths leading to and from the premises and in car parks

Necessary and appropriate conditions should normally focus on the most sensitive periods (2.22) and may address disturbance as customers enter or leave the premises but it is essential that conditions are focused on measures within the direct control of the licence holder.

Appendix 11

Anti-Social Behaviour on the Premises

Licensing Policy

The Licensing Authority expects the applicant to have addressed all crime and disorder issues relating to the premises in their operating schedule and to have sought appropriate advice. (**See Section 6 of the Licensing Policy**)

The Licensing Authority will consider attaching conditions to deter crime and disorder and these may include conditions drawn from the Model Poll of Conditions relating to Crime and Disorder. (**See Appendix 3 of the Licensing Policy**). In particular Members may wish to consider (this list is not exhaustive):

- Methods of management communication
- Use of registered Door Supervisors
- Bottle Bans
- Plastic containers
- CCTV
- Restrictions on open containers for “off sales”
- Restrictions on drinking areas
- Capacity
- Proof of Age scheme
- Crime prevention notices
- Drinks promotions-aimed at stopping irresponsible promotions
- Signage
- Seating plans
- Capacity

If Members believe that there is a substantial problem of anti-social behaviour and it cannot be proportionately addressed by licensing conditions they should refuse the application.

Police Powers

The Licensing Act 2003, Part 8 gives a senior police officer the power to close a premises for up to 24 hours where the officer believes there is, or is likely to be disorder on or in the vicinity and closure is necessary in the interests of public safety.

Guidance Issued under Section 182 of the Licensing Act 2003

The pool of conditions, adopted by the Council is recommended (Annexe D).

The key role of the Police and SIA is acknowledged (2.1-2.2).

Conditions attached to licences cannot seek to manage the behaviour of customers once they are beyond the direct management of the licence holder and their staff or agents, but can directly impact on the behaviour of

Customers in the immediate vicinity of the premises as they seek entry or leave (1.16).

Conditions are best targeted on deterrence and preventing crime and disorder (2.3) communication, CCTV, police liaison, no glasses, capacity limits are all relevant (2.3 - 2.7).

Guidance Issued under Section 182 of the Licensing Act 2003

Conditions can be imposed for large capacity “vertical consumption” premises (10.23 – 10.24).

Guidance Issued by the Office of Fair Trading

This relates to attempts to control minimum prices.

Other Legislation

- The Council has a duty under Section 17 of the Crime and Disorder Act 1998 to do all it reasonably can to prevent crime and disorder.

Appendix 12

Anti-Social Behaviour from Patrons Leaving the Premises

General Advice

Members need to bear in mind that once patrons have left a premises they are no longer under direct control. Members will need to be satisfied that there is a link between the way the premises is operating and the behaviour that is complained of. An example of this would be that irresponsible drinking is being encouraged. Before deciding that any particular licensing conditions are proportionate, Members will also need to be satisfied that other legislation is not a more effective route. For example, if the problem is drinking in the street it may be that the Council should designate the area as a place where alcohol cannot be consumed in public.

Members may also wish to consider whether the hours of opening relate to any problems of anti-social behaviour.

If Members believe that there is a substantial problem of anti-social behaviour and it cannot be proportionately addressed by licensing conditions they should refuse the application.

Licensing Policy

The policy recognises that other legislation or measures may be more appropriate but also states that licensing laws are “a key aspect of such control and will always be part of an overall approach to the management of the evening and night time economy” (**see Section 4.15 and 4.16 of the Licensing Policy**).

The Licensing Authority expects the applicant to have addressed all crime and disorder issues relating to the premises in their operating schedule and to have sought appropriate advice. (**See Sections 6.2 of the Licensing Policy**)

The Licensing Authority will consider attaching conditions to deter crime and disorder and these may include Conditions drawn from the Model Poll of Conditions relating to Crime and Disorder. (**See Appendix 3 of the Licensing Policy**). In particular Members may wish to consider (this list is not exhaustive):

- Bottle Bans
- Plastic containers
- CCTV (outside the premises)
- Restrictions on open containers for “off sales”
- Proof of Age scheme
- Crime prevention notices
- Drinks promotions-aimed at stopping irresponsible promotions
- Signage

Cumulative Impact

There is a process by which the Licensing Authority can determine that an area is saturated following representations. However, the process for this involves wide consultation and cannot come from representations about a particular application. (**See Section 7 of the Licensing Policy**).

Police Powers

The Licensing Act 2003, Part 8 gives a senior police officer the power to close a premises for up to 24 hours where the officer believes there is, or is likely to be disorder on or in the vicinity and closure is necessary in the interests of public.

Guidance Issued under Section 182 of the Licensing Act 2003

The key role of the Police is acknowledged (2.1).

Conditions attached to licences cannot seek to manage the behaviour of customers once they are beyond the direct management of the licence holder, but can relate to the immediate vicinity of the premises as they seek entry or leave (1.16).

Conditions are best targeted on deterrence and preventing crime and disorder (2.3) CCTV inside & out, communication, police liaison, no glasses are all relevant

There is also guidance issued around public nuisance (2.14 – 2.20).

The pool of conditions, adopted by the Council is recommended (see Appendix 3 of the Licensing Policy). Licence conditions should not duplicate other legislation (1.16).

Necessary and appropriate conditions should normally focus on the most sensitive periods and may address disturbance as customers enter or leave the premises but it is essential that conditions are focused on measures within the direct control of the licence holder (2.18/2.20).

Licensing law is not the primary mechanism for the general control of nuisance and anti-social behaviour by individuals once they are away from the licensed premises and, therefore, beyond the direct control of the individual, club or business holding the licence, certificate or authorisation concerned (13.13).

Other Legislation

Crime and Disorder Act 1998

The Council has a duty under Section 17 of the Crime and Disorder Act 1998 to do all it reasonably can to prevent crime and disorder.

The Act also introduced a wide range of measures designed to address anti-social behaviour committed by adults and young people. These include:

- Anti-Social Behaviour Orders
- Child Curfew Schemes
- Truancy
- Parenting Orders
- Reparation Orders
- Tackling Racism

Appendix 13

Planning

An application for a Premises Licence can be made in respect of a premises even where the premises does not have relevant Planning Permission. That application has to be considered and Members can only refuse the application where the application itself does not promote one of more of the Licensing Objectives. Members cannot refuse just because there is no planning permission. Where a Premises Licence is granted and which exceeds what is allowed by the Planning Permission and that Premises then operates in breach of planning then the operator would be liable to enforcement by Planning.

Appendix 14

Licensing Policy Relating to Hours of Trading

All applications have to be considered on their own merits.

The Council has however adopted a set of framework hours as follows:

- Monday to Thursday, from 06:00 hrs to 23:30 hrs
- Friday and Saturday, from 06:00 hrs to 00:00 hrs (midnight)
- Sunday, from 06:00 hrs to 22:30 hrs

(see 15.8 of the Licensing Policy)

In considering the applicability of frame work hours to any particular application regard should be had to the following

- Location
- Proposed hours of regulated activities, and the proposed hours the premises are open to the public
- The adequacy of the applicant's proposals to deal with issues of crime and disorder and public nuisance
- Previous history
- Access to public transport
- Proximity to other licensed premises, and their hours

(See 15.9 of the licensing policy)

Subject to any representations to the contrary in individual cases the following premises are not generally considered to contribute to late night anti-social behaviour and will therefore generally have greater freedom

- Theatres
- Cinemas
- Premises with club premises certificates